

Signet Pressure Integral Systems with 9900 Transmitter



Member of the SmartPro® Family of Instruments



Signet has combined the 9900 SmartPro® Transmitter with the 2450 Pressure sensors to create integral systems for level applications that are easy to order and simple to install. Also available in conductivity, temperature, and flow configurations, each integral system features a 9900 Transmitter which provides a local and easy to read LCD display. The push button keypad makes it easy to navigate through the transmitter's menu. The DC-powered 9900 features a scalable 4 to 20 mA output and open collector for process control.

The integral system offers a local display, a scalable 4 to 20 mA output and open collector for process control. A 2450 Pressure sensor with wetted material of ceramic and PVDF installs into a 1/2" union fitting. The 2450 Pressure sensor is offered in three pressure ranges which could also be used as a hydrostatic level for tank level management.

Features

- Utilizes the 2450 sensor for pressure or hydrostatic level measurement
- Local display for sensor mounted instruments
- Provides 4 to 20 mA output
- "At a glance" visibility
- "Dial-type" digital bar graph
- NEMA 4X/IP65



Applications

- Water Quality
- Filtration Systems
- Chemical Production
- Liquid Delivery Systems
- Level Management
- Media Filtration
- Reverse Osmosis Systems

System Overview

Integral Installation

Signet Model 9900 Transmitter
with 3-8052 Integral Mount Kit



Signet 2450
Pressure Sensor



Customer supplied standard 3/4 in fittings

Specifications

See individual transmitter and sensor product pages for more information.

Sensor can be mounted through the side of a tank for hydrostatic level measurement. **Tip:** Add a ball valve to isolate the sensor from the tank to allow the removal of the sensor for service.

| Pressure/Level Ranges*: | |
|-------------------------|--|
| 3-2250-XU | 0 to 10 psi = 0 to 7.03 meters = 0 to 23.06 ft |
| 3-2250-XL | 0 to 50 psi = 0 to 35.15 meters = 0 to 115.32 ft |

It is not recommended to use the 2450 Pressure sensor mounted inside a tank. For all tank installations where the sensor is mounted inside a tank, use 3-2250 Hydrostatic Level sensor only.

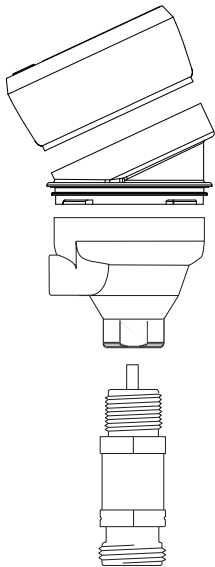

Dimensions

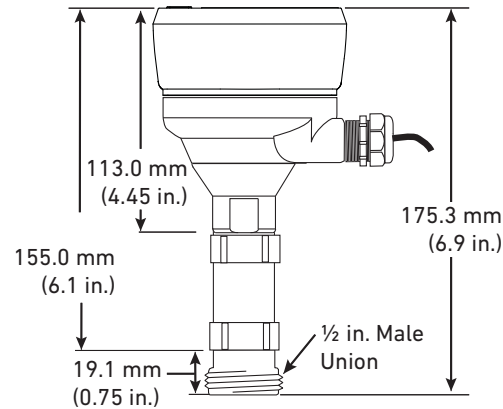

Ordering Notes

Integral Mounts are available with all parts conveniently assembled (transmitter, sensor, and mounting kit). Alternatively, all three parts can be purchased separately. See individual transmitter and sensor pages for more information.

Only available in Europe.

Ordering Information

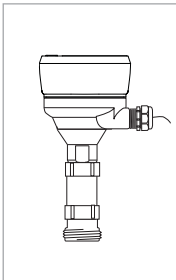

| Mfr. Part No./ Code | Instrument + Sensor | Description |
|---------------------|----------------------|--|
| 159 001 726 | 3-9900-1 + 3-2450-3U | 0 - 0.7 bar (0 - 10 psi), 1/2 in. Union process connection |
| 159 001 727 | 3-9900-1 + 3-2450-3L | 0 - 3.4 bar (0 - 50 psi), 1/2 in. Union process connection |
| 159 001 744 | 3-9900-1 + 3-2450-3H | 0 - 17 bar (0 - 250 psi), 1/2 in. Union process connection |

Accessories

| Mfr. Part No. | Code | Description |
|---------------|-------------|------------------------------|
| 3-9900.396 | 159 001 701 | Angle adjustment adapter kit |

Please refer to Wiring, Installation, and Accessories sections for more information.